

Foodservice Equipment • Material Handling, Healthcare & Cleanroom Equipment • Retail Display

Spec-Bar-2000® Hand Sinks



Item #:	_____
Model #:	_____
Project #:	_____
SIS #:	_____

Optional Accessories	Model #	Qty.
Removable plastic perforated strainer		



- Body, legs and crossbracing constructed of type 304 stainless steel for strength and corrosion resistance.
- Stainless steel adjustable bullet feet.
- Sink bowl is 9¼" x 11½" x 6" (235 x 292 x 152mm) deep with hot and cold water gooseneck faucet.
- Deluxe models feature front access hinged door, soap dispenser and paper towel dispenser.

Spec sheets available for viewing, printing or downloading from our online literature library at www.eaglegrp.com

Spec-Bar-2000® Hand Sinks

Design and Construction Features

- 1½"(38mm) I.P.S. threaded drain with nut and washer.
- Faucets are deck mounted on 4" (102mm) centers with ½" (13mm) NPT inlet and hot and cold water connections required.
- Sink bowl dimensions are 9¼" by 11½" by 6" deep (235 x 292 x 152mm).
- Legs are 1½" (41mm) diameter type 304 stainless steel with stainless steel bullet feet.
- Backsplash, sides, bottom, front panel or door, and bowl are 20 gauge stainless steel. Leg channels, legs and crossbracing are 16 gauge stainless steel.

19" (483mm)-wide Units

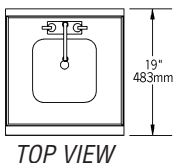

width x length		weight		model #
in.	mm	lbs.	kg	
19" x 12"	483 x 305	30	13.6	HS12-19
19" x 18"	483 x 457	35	15.9	HS18-19

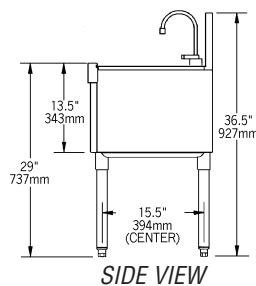
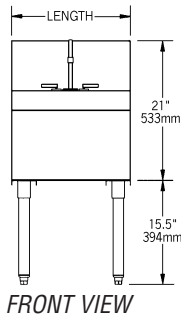

24" (610mm)-wide Units

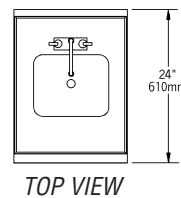

width x length		weight		model #
in.	mm	lbs.	kg	
24" x 12"	610 x 305	35	15.9	HS12-24
24" x 18"	610 x 457	40	18.1	HS18-24

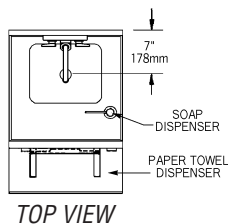
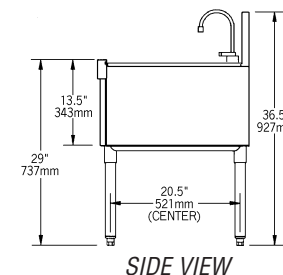
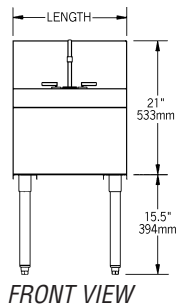

width x length		weight		model #
in.	mm	lbs.	kg	
19" x 18"	483 x 457	45	20.4	HSD18-19

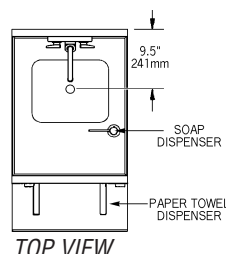
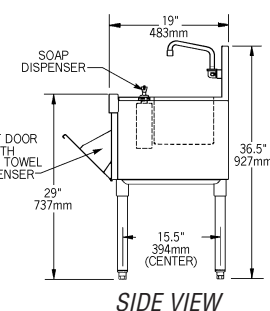
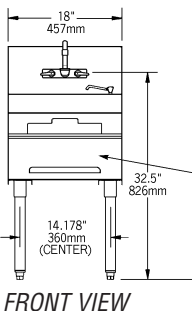

width x length		weight		model #
in.	mm	lbs.	kg	
24" x 12"	610 x 305	45	20.4	HSD12-24
24" x 18"	610 x 457	50	22.7	HSD18-24

